

PLOT AREA OF F.P. NO. 192 :- 3191.00 SQ.MTR.
BASEMENT BUILT UP AREA :- 910.80 SQ.MTR.
GROUND FLOOR BUILT UP AREA :- 984.64 SQ.MTR.
FIRST FLOOR BUILT UP AREA :- 945.75 SQ.MTR.
TERRACE FLOOR BUILT UP AREA :- 191.39 SQ.MTR.
TOTAL BUILT UP AREA :- 3032.58 SQ.MTR. (750 PERSON CAPACITY)

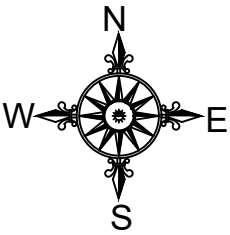

DATE : 18/08/2025	SCALE N.T.S.	DRG. NO. L-01	TITLE :
PROJECT NO. AMCNZHALL2025	VP	RM	SITE LAYOUT PLAN
ISSUE FOR EXECUTION	DRAWN BY	CHECKED BY	
PROJECT :			
CONSTRUCTION OF COMMUNITY HALL BUILDING AT F.P. NO :- 192, T.P.S. NO :- 12 (ASARVA EXTENSION SOUTH) IN BAPUNAGAR WARD,NORTH ZONE			
AHMEDABAD			PH. : 99099 - 67778 , 94260 - 72236 ARCHITECTS & STRUCTURAL CONSULTANTS

RUPESH MODI

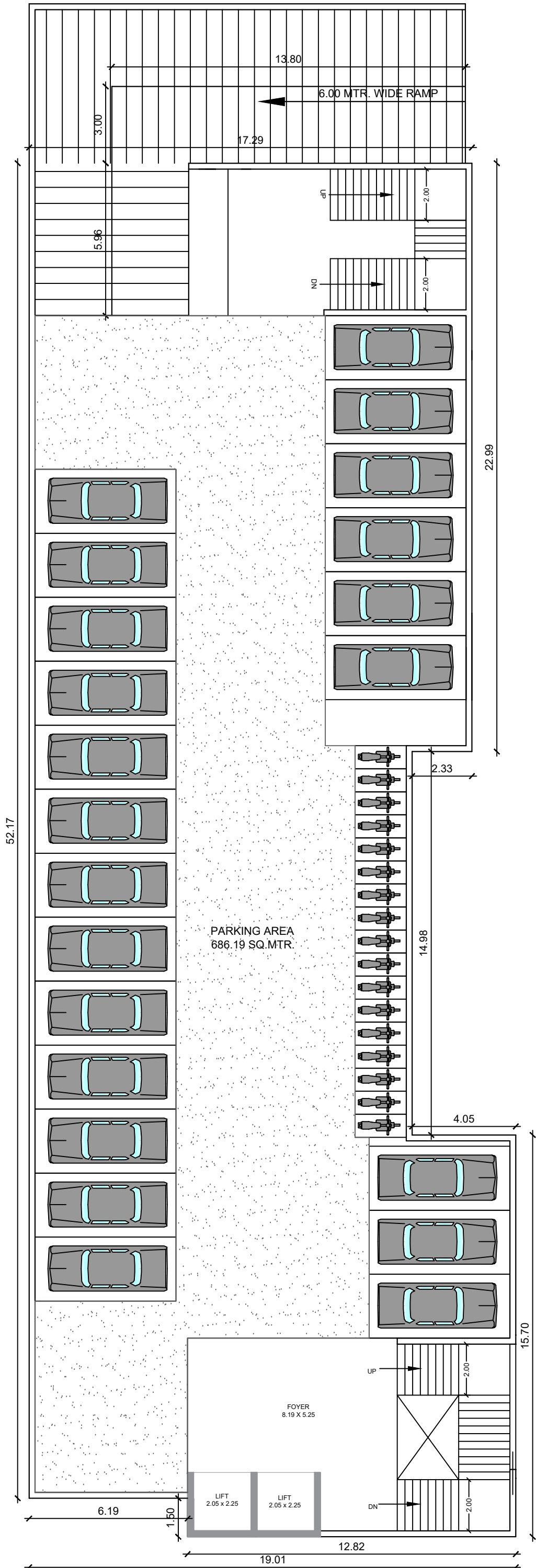

DATE :	18/08/2025	SCALE	N.T.S.	DRG. NO.	O-01
PROJECT NO.	AMCNZHALL2025	VP	RM		
ISSUE FOR	EXECUTION	DRAWN BY	CHECKED BY		
PROJECT :					
CONSTRUCTION OF COMMUNITY HALL BUILDING AT F.P. NO :- 192, T.P.S. NO :- 12 (ASARVA EXTENSION SOUTH) IN BAPUNAGAR WARD,NORTH ZONE					
AHMEDABAD					
TITLE :					
BASEMENT FLOOR PLAN					
PH. : 99099 - 67778 , 94260 - 72236					
ARCHITECTS & STRUCTURAL CONSULTANTS					

RUPESH MODI

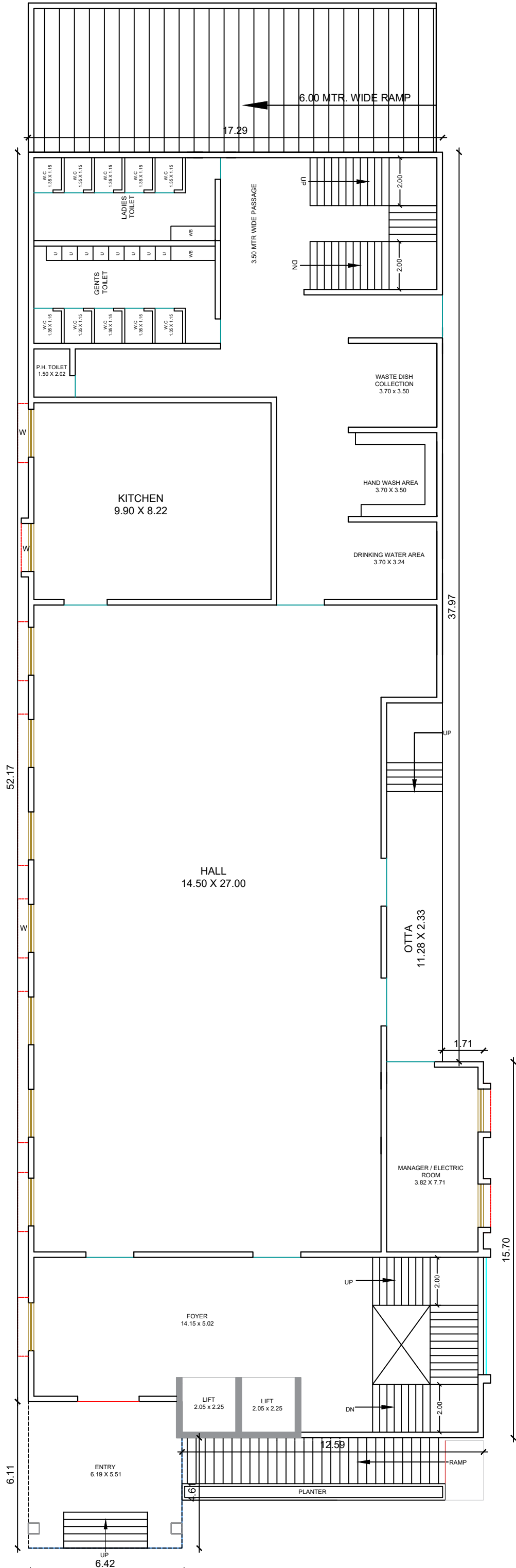

GROUND FLOOR BUILT UP AREA :- 984.64 SQ.MTR.

DATE : 18/08/2025		SCALE		N.T.S.		DRG. NO. O-02	
PROJECT NO.		AMCNZHALL2025		VP		RM	
ISSUE FOR		EXECUTION		DRAWN BY		CHECKED BY	
PROJECT : CONSTRUCTION OF COMMUNITY HALL BUILDING AT F.P. NO :- 192, T.P.S. NO :- 12 (ASARVA EXTENSION SOUTH) IN BAPUNAGAR WARD,NORTH ZONE <							

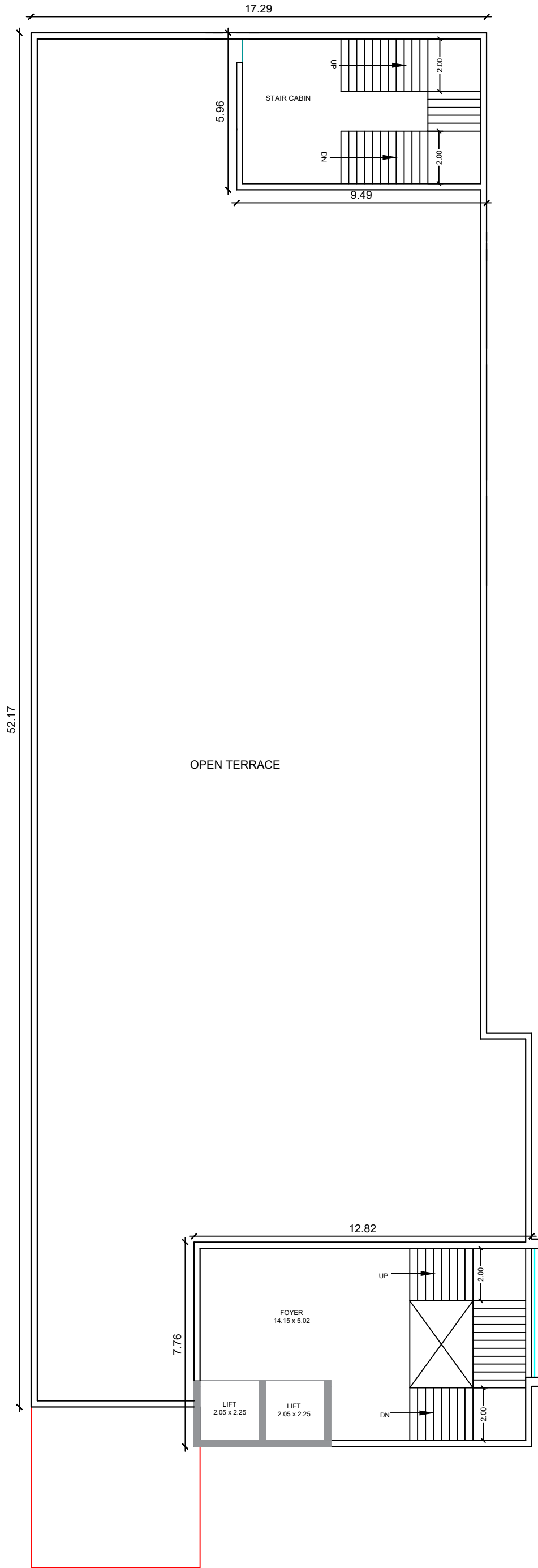

TERRACE FLOOR BUILT UP AREA :- 191.39 SQ.MTR.

DATE : 18/08/2025		SCALE		N.T.S.		DRG. NO. O-04	
PROJECT NO.		AMCNZHALL2025		VP		RM	
ISSUE FOR		EXECUTION		DRAWN BY		CHECKED BY	
PROJECT : CONSTRUCTION OF COMMUNITY HALL BUILDING AT F.P. NO :- 192, T.P.S. NO :- 12 (ASARVA EXTENSION SOUTH) IN BAPUNAGAR WARD,NORTH ZONE <							